

TK00 4353

## Dimensional sketches

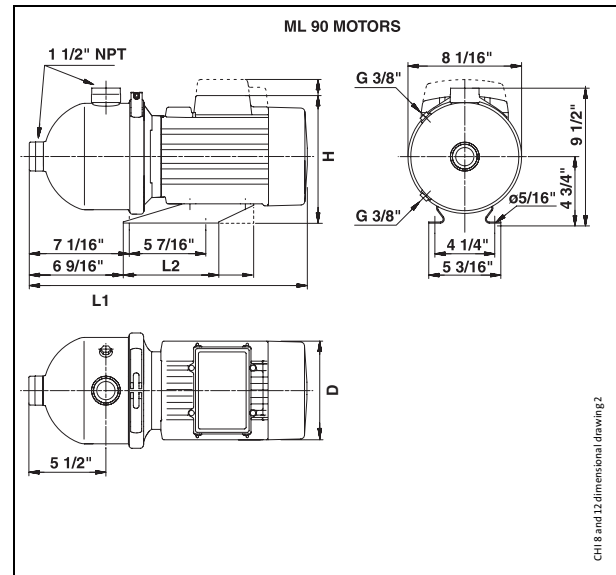
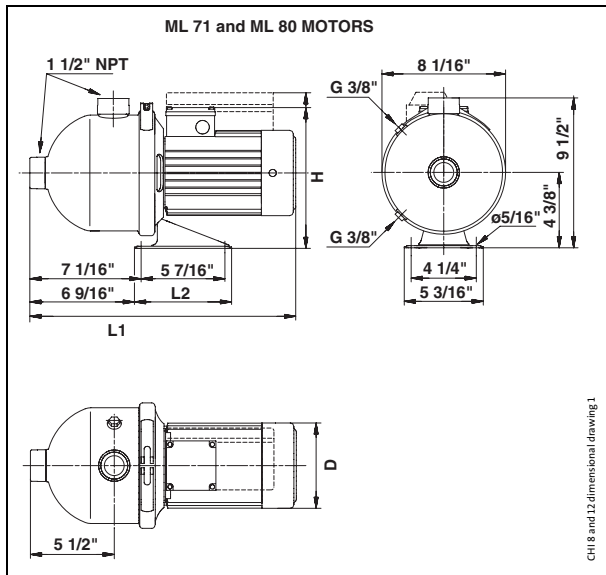

## Dimensions/weights/electrical data

Pump Type	Electrical Data						Dimensions [in.]				Motor type	Ship Wt. [lbs.]	Ship Vol. [ft <sup>3</sup> ]
	Hp	Ph	Voltage	Service Factor	Rated Current [A]	Maximum Current [A]	L1	L2	H	D			
CHI 8-10	3/4	1	115/230	1.5	10.6/5.3	11.5/5.7	17 1/4	6 3/8	10	5 5/8	ML 80	33	1.4
	3/4	3	208-230/460	1.7	3.6/1.8	4.0/2.1	15 5/8	6 3/8	9 1/16	5 5/8	ML 71	29	
	3/4	3	575	1.7	1.44	2.45	15 5/8	6 3/8	9 1/16	5 5/8	ML 71	29	
CHI 8-20S	1	1	115/230	1.5	14.6/7.3	15.0/7.5	17 1/4	6 3/8	9 1/16	5 5/8	ML 80	37	1.4
	1	3	208-230/460	1.6	5.0/2.5	5.2/2.6	17 1/4	6 3/8	9 1/16	5 5/8	ML 80	31	
	1	3	575	1.6	2	3.2	17 1/4	6 3/8	9 1/16	5 5/8	ML 80	31	
CHI 8-15	1 1/2	1	115/230	1.4	18.2/9.3	21.5/10.7	19 11/16	6 13/16	10 1/4	7	ML 90	61	1.4
	1 1/2	3	208-230/460	1.5	5.8/2.9	6.9/3.5	17 1/4	6 3/8	9 1/16	5 5/8	ML 80	35	
	1 1/2	3	575	1.5	2.32	3.5	17 1/4	6 3/8	9 1/16	5 5/8	ML 80	35	
CHI 8-20	1 1/2	1	115/230	1.4	21.5/10.7	21.5/10.7	19 11/16	6 13/16	10 1/4	7	ML 90	62	1.4
	1 1/2	3	208-230/460	1.5	6.9/3.5	6.9/3.5	17 1/4	6 3/8	9 1/16	5 5/8	ML 80	36	
	1 1/2	3	575	1.5	2.8	4.12	17 1/4	6 3/8	9 1/16	5 5/8	ML 80	36	